

EXISTING 1.5m³ OF ATTENUATION TO ACT AS A SOAKAWAY CONSISTING OF AQUA CELL 'ECO' STORAGE BLOCKS 2 UNITS x 2 UNITS x 2 UNIT (1m x 2m x 0.8m @ 95% VOID RATIO)

EXISTING DRAINAGE NOTES

THE LOCATION LINE & LEVEL OF ALL KNOWN EXISTING DRAINAGE PIPEWORK INDICATED ON THIS DRAWING IS APPROXIMATE AND FOR GUIDANCE PURPOSES ONLY.

- KEY**
- FWS EXISTING FOUL WATER SEWER
 - SWS EXISTING SW SEWER
 - CFS EXISTING COMBINED SEWER
 - HD EXISTING HIGHWAY DRAIN
 - EXISTING FOUL DRAIN
 - EXISTING SW DRAIN
 - EXISTING COMBINED FLOW DRAIN
 - sfr SHOWN FROM RECORD INFORMATION

THE CONTRACTOR SHALL MAKE ALLOWANCE FOR RAISING / LOWERING ALL EXISTING ACCESS COVERS & FRAMES TO SUIT NEW FINISHED LEVELS.

THIS DRAWING HAS BEEN PRODUCED BY COMPARING INFORMATION FROM VARIOUS RECORD PLANS AGAINST THE TOPOGRAPHICAL SURVEY DATA OBTAINED. AS SUCH THE ACCURACY CANNOT BE GUARANTEED AND THE CONTRACTOR IS TO VERIFY THE EXISTING LAYOUT & LEVELS PRIOR TO COMMENCEMENT OF ANY DRAINAGE WORKS.

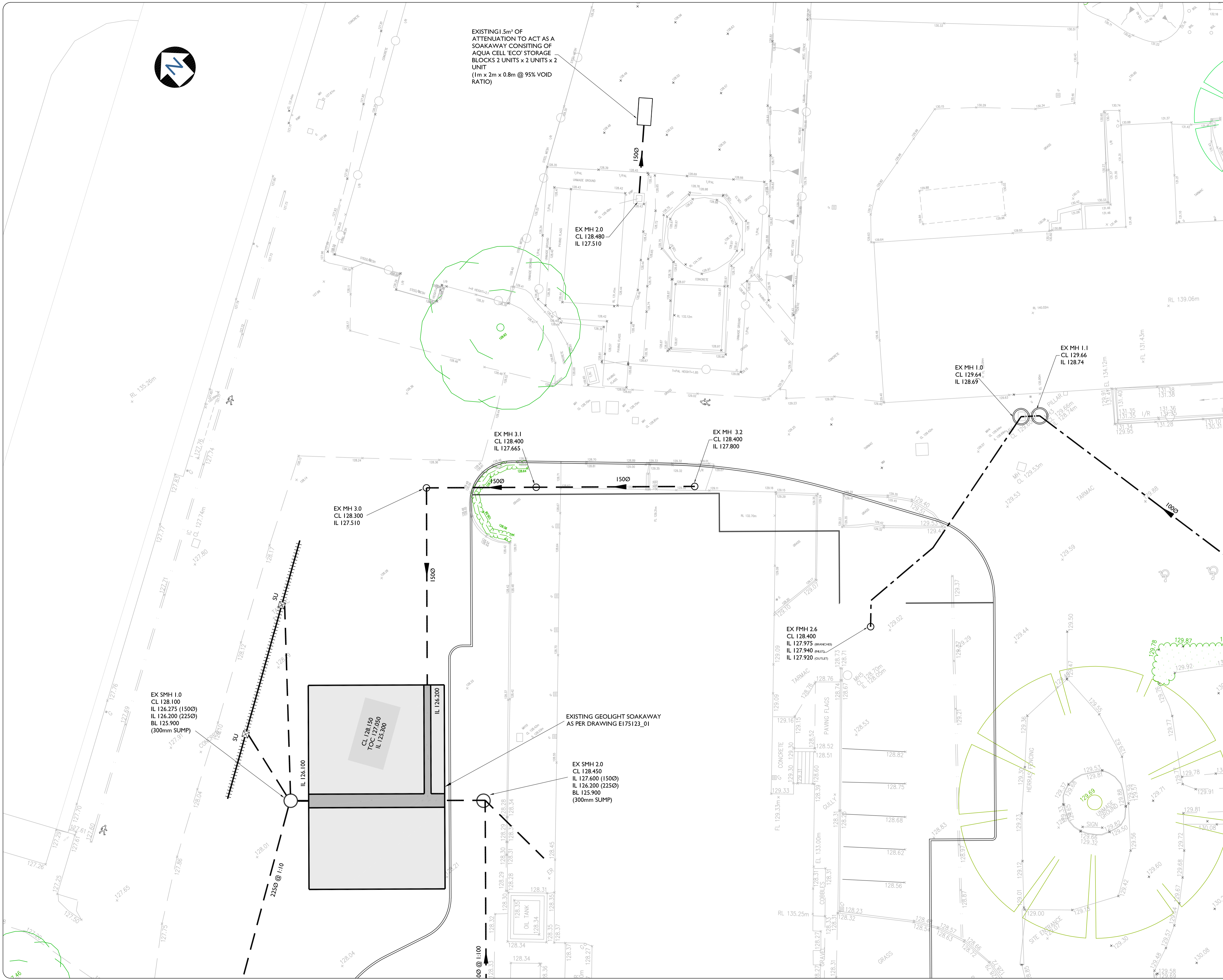

REV	DESCRIPTION	BY	CHK	APR	DATE

JPS CIVIL + STRUCTURAL ENGINEERS
 +44 (0)1244 956000 | www.jpsstructural.co.uk | info@jpsstructural.co.uk

PURPOSE OF ISSUE	PRELIMINARY	STATUS	P
PROJECT	LLYFSASI HOSTEL		
TITLE	DRAINAGE SCHEME EXISTING LAYOUT		
CLIENT	COLEG CAMBRIA		
DRAWN BY	RH	CHECKED BY	MM
DATE	08.08.2024	APPROVED BY	JP
DRAWING NUMBER	0601	SCALE (@ A1)	1:125
		PROJECT NUMBER	16024
		REV	P01